

Integro Inserting Machine

Technical Data

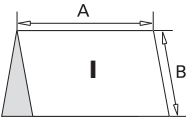
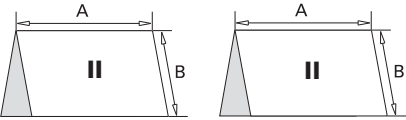
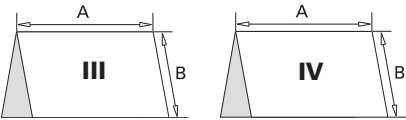

Mechanical speed		maximum 30,000 cycles/hour
Pin spacing on track		406.4 mm (16")
Number of stations		maximum 4 feeders (single and/or twin feeders)
Main products	Size A	maximum 334 mm (13 ³ / ₁₆ " minimum 194 mm (7 ⁵ / ₈ "
	Size B	maximum 272 mm (10 ¹¹ / ₁₆ " minimum 145 mm (5 ¹¹ / ₁₆ "
	Product thickness	maximum 13 mm (1/2") minimum 32 pages
	Single feeder (two identical inserts)	Size A
	Size B	maximum 272 mm (10 ¹¹ / ₁₆ " minimum 105 mm (4 ¹ / ₁₆ "
	Product thickness	maximum 4 mm (5/32") minimum single sheet min. 120 g/m ²
	Loading	manual or with Streamfeeder 3738 on every second feeder
Twin feeder (two different inserts)	Size A	maximum 320 mm (12 ⁵ / ₈ " minimum 148 mm (5 ¹³ / ₁₆ "
	Size B	maximum 272 mm (10 ¹¹ / ₁₆ " minimum 105 mm (4 ¹ / ₁₆ "
	Product thickness	maximum 3 mm (1/2") minimum single sheet min. 120 g/m ²
	Loading	manual or with Streamfeeder 3738 on every second feeder
Total product thickness (main product including inserts)		maximum 13 mm (0.51")
Vacuum		80%/-0.8 bar* (80%/11.6 psi)
Blow air		1,5 bar* (21.75 psi)
Compressed air		6 bar* (87 psi)
Drive rating	for 4 single feeders	22 kW
	for 4 twin feeders	33 kW

Design, machine configuration and specifications subject to change.
*Requirements depend on project

Integro 0434

- | | |
|--|---|
| <ul style="list-style-type: none"> 1 Infeed 2 Channel element 3 Single feeder with hand loading 4 Single feeder with Streamfeeder Universal 3738 5 Single feeder with Streamfeeder Universal 3738 and extension | <ul style="list-style-type: none"> 6 Twin feeder with hand loading 7 Twin feeder with Streamfeeder Universal 3738 8 Twin feeder with Streamfeeder Universal 3738 and extension 9 Delivery 10 Control cabinet |
|--|---|

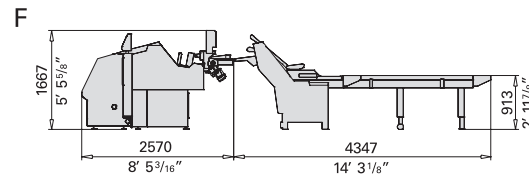
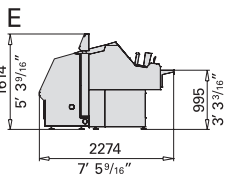
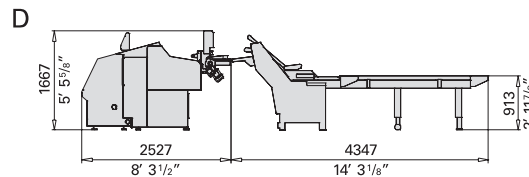
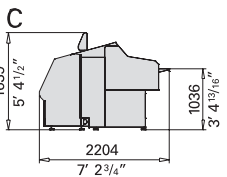
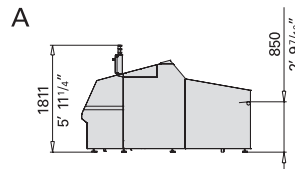
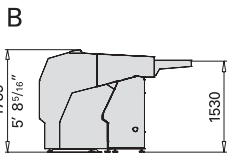
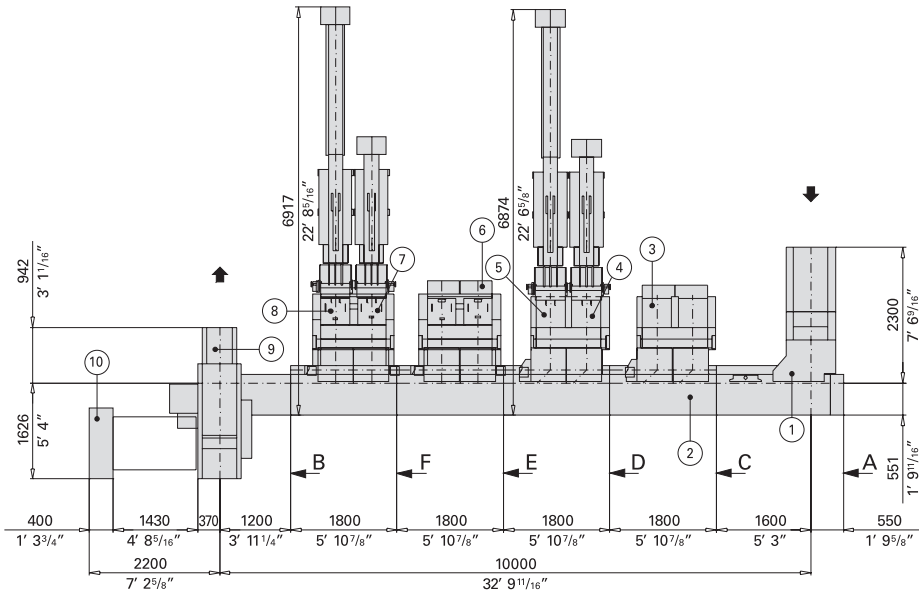

Müller Martini Marketing AG
 Untere Brühlstrasse 13
 CH-4800 Zofingen, Switzerland
 Phone +41 (0)62 745 45 75
 Fax +41 (0)62 751 55 50
 info@mullermartini.com
 www.mullermartini.com